

Société de Promotion Immobilière Pour la Vente et la Location
PROJET DE CONSTRUCTION D'UN CENTRE DE VIE - MGHIRA III

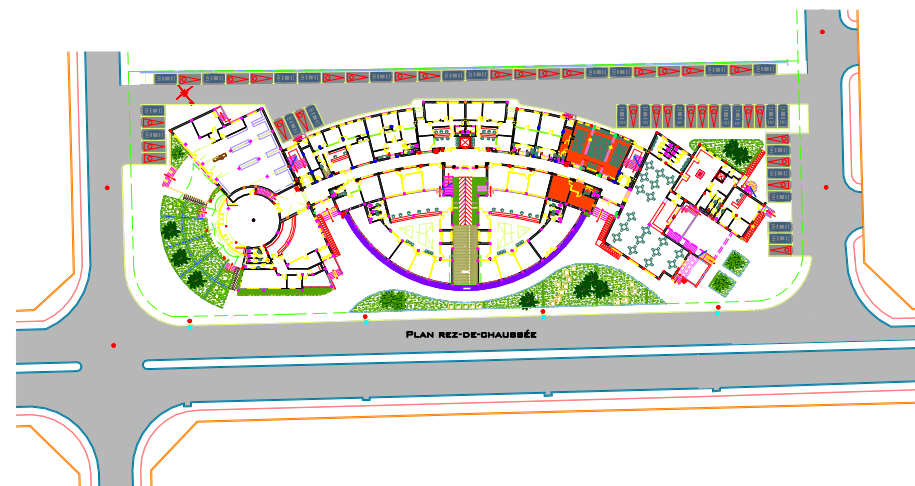
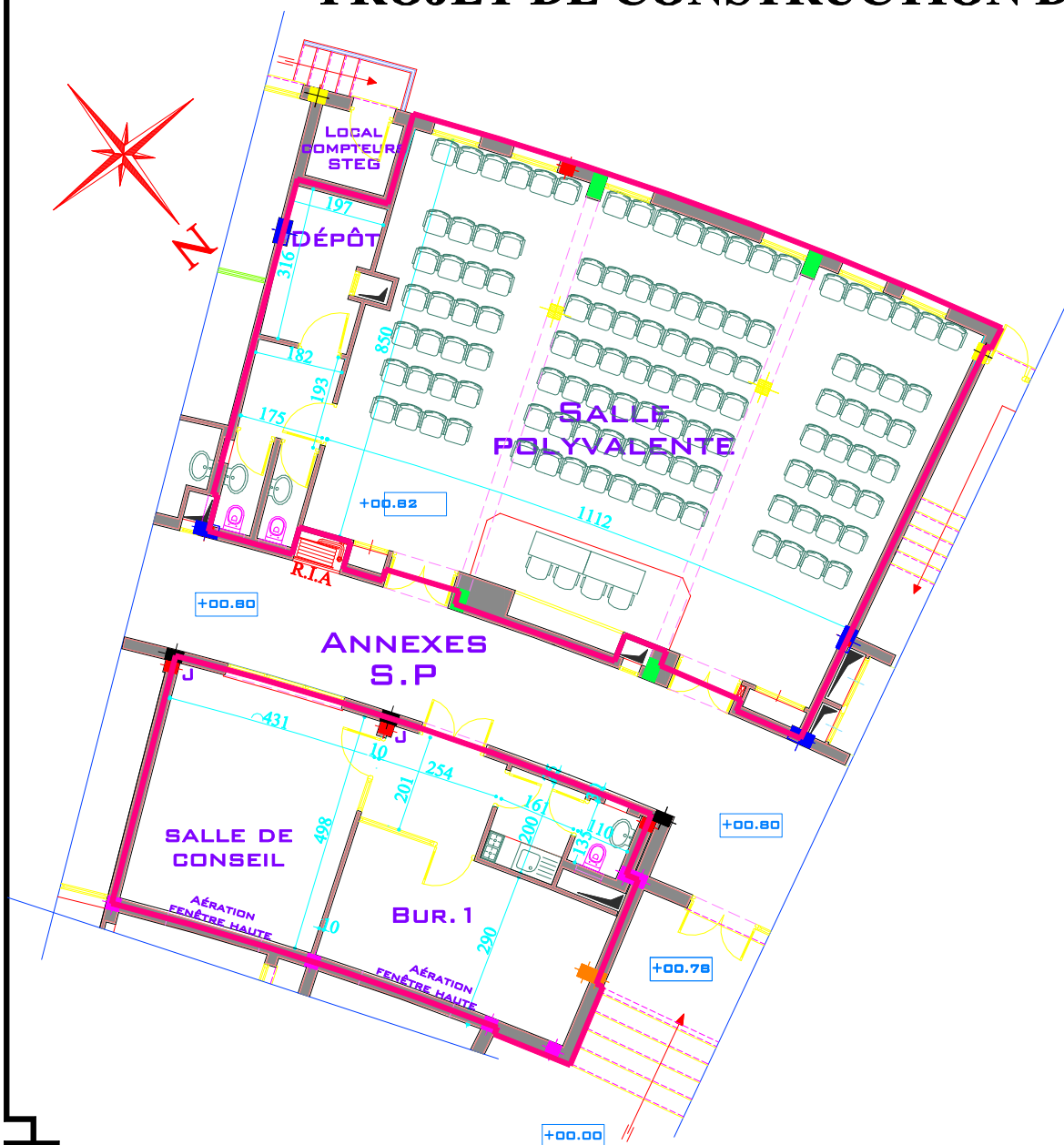

SALLE POLYVALENTE

Niveau:	R.D.C
Surface Utile:	160.75 m ²
Surface HD:	179.71 m ²
Surface Commune:	32.51 m ²
Surf Vendable:	212.22 m ²